

**3000 kg capacity**

**Reinforced frame**

**Fast lift supplied as standard**

**Unique operating element**

**Robust and durable**

**Short and manoeuvrable**



## AM 3000

### Hand pallet truck (3000 kg)

The hand pallet trucks AM 3000 is the ideal solution for all manual transport tasks over short distances. It is a universally suitable truck with its extraordinarily high capacity – for very heavy loads as well as for loads that exceed the usual dimensions. Its advantages are detailed here:

- Comfortable and easy to handle operating element for both left-handed and

right-handed operators. Manoeuvring with one hand on the tiller head is possible and both comfortable and safe.

- Fast lift (up to 120 kg) with supplied as standard for off the floor lifting and lowering of pallets in only three pump strokes.
- Excellent manoeuvrability even in most confined spaces through slim front length.

Chromed bearing bushes on wheels and joints make for easy pulling or pushing. They are convincing with their remarkably quiet running and maintenance free operation.

# AM 3000

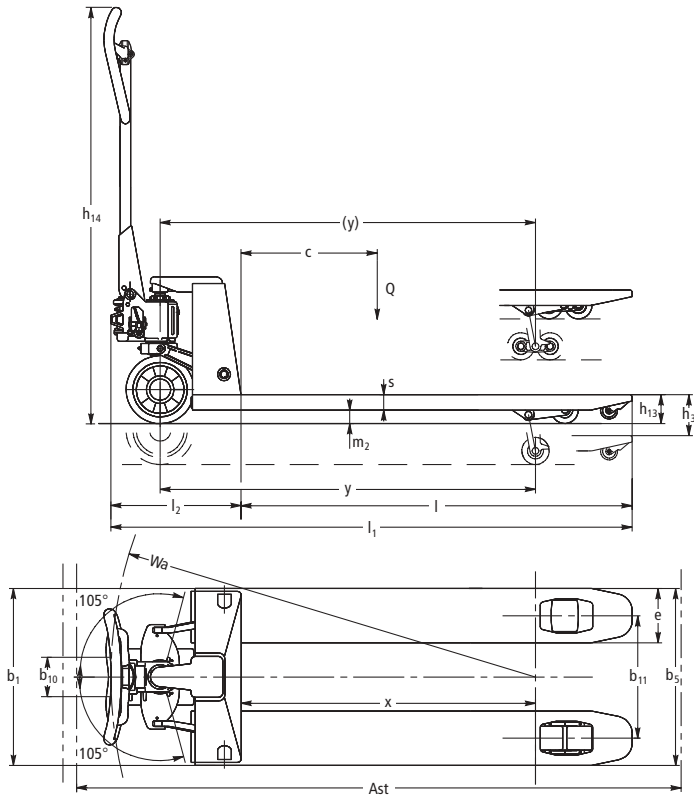

# Technical Data in line with VDI 2198 as at: 09/2005

|                  |                  |  |                                   |                |           |     |
|------------------|------------------|--|-----------------------------------|----------------|-----------|-----|
| Identification   | 1.1              | Manufacturer (abbreviation)  | Jungheinrich                      | Jungheinrich   | 1.1       |     |
|                  | 1.2              | Manufacturer's type designation                                      | <b>AM 3000</b>                    | <b>AM 3000</b> | 1.2       |     |
|                  | 1.3              | Drive: electric (battery or mains), diesel, petrol, fuel gas, manual | manual                            | manual         | 1.3       |     |
|                  | 1.4              | Type of operation: hand, pedestrian, standing, seated, order picker  | hand                              | hand           | 1.4       |     |
|                  | 1.5              | Load capacity/rated load Q (t)                                       | 3                                 | 3              | 1.5       |     |
|                  | 1.6              | Load centre distance c (mm)  | 600                               | 1050           | 1.6       |     |
|                  | 1.8              | Load distance, centre of drive axle to fork x (mm)                   | 936                               | 1801           | 1.8       |     |
|                  | 1.9              | Wheelbase y (mm)   | 1174                              | 2039           | 1.9       |     |
|                  | Weights          | 2.1  | Service weight kg                 | 86             | 142       | 2.1 |
| 2.2              |                  | Axle loading, laden front/rear kg                                    | 815/2270                          | 1135/2007      | 2.2       |     |
| 2.3              |                  | Axle loading, unladen front/rear kg                                  | 27.5/57.5                         | 57/85          | 2.3       |     |
| Wheels, Chassis  | 3.1              | Tyres: solid rubber, superelastic, pneumatic, polyurethane           | V                                 | V              | 3.1       |     |
|                  | 3.2              | Tyre size, front   | 200                               | 200            | 3.2       |     |
|                  | 3.3              | Tyre size, rear  | 80 x 70                           | 80 x 70        | 3.3       |     |
|                  | 3.5              | Wheels, number front/rear (x = driven wheels)                        | 2/4                               | 2/4            | 3.5       |     |
|                  | 3.6              | Track width, front b <sub>10</sub> (mm)                              | 116                               | 116            | 3.6       |     |
|                  | 3.7              | Track width, rear b <sub>11</sub> (mm)                               | 390                               | 390            | 3.7       |     |
|                  | Basic Dimensions | 4.4  | Lift height h <sub>3</sub> (mm)   | 120            | 120       | 4.4 |
| 4.9              |                  | Height of tiller in drive position min./max. h <sub>14</sub> (mm)    | 1224                              | 1224           | 4.9       |     |
| 4.14             |                  | Standing height, elevated h <sub>12</sub> (mm)                       | 205                               | 205            | 4.14      |     |
| 4.15             |                  | Lowered height h <sub>13</sub> (mm)                                  | 85                                | 85             | 4.15      |     |
| 4.19             |                  | Overall length l <sub>1</sub> (mm)                                   | 1603                              | 2483           | 4.19      |     |
| 4.20             |                  | Length to face of forks l <sub>2</sub> (mm)                          | 383                               | 383            | 4.20      |     |
| 4.21             |                  | Overall width b <sub>1</sub> /b <sub>2</sub> (mm)                    | 550                               | 550            | 4.21      |     |
| 4.22             |                  | Fork dimensions s/e/l (mm)   | 45/160/1220                       | 63/160/2100    | 4.22      |     |
| 4.25             |                  | Width over forks b <sub>5</sub> (mm)                                 | 550                               | 550            | 4.25      |     |
| 4.32             |                  | Ground clearance, centre of wheelbase m <sub>2</sub> (mm)            | 36                                | 18             | 4.32      |     |
| 4.33             |                  | Aisle width for pallets 1000 x 1200 crossways Ast (mm)               | 1803                              | 2683           | 4.33      |     |
| 4.34             |                  | Aisle width for pallets 800 x 1200 lengthways Ast (mm)               | 1803                              | 2683           | 4.34      |     |
| 4.35             |                  | Turning radius Wa (mm)   | 1319                              | 2184           | 4.35      |     |
| Performance Data |                  | 5.3  | Lowering speed, laden/unladen m/s | 0.09/0.05      | 0.09/0.05 | 5.3 |
|                  |                  |  |                                   |                |           |     |
|                  |                  |  |                                   |                |           |     |

# Make use of the advantages

## Effortless transport of heavy loads

- The special reinforcements of load-carrying parts makes the AM 3000 ideally suitable for the transport of particularly heavy loads

## Designs for every application

- Varying fork lengths ensure that even loads with extreme centres of gravity can be transported safely.

## Easy to handle

- The smooth running operating element is equally suitable for left-handed and right-handed operators.
- The special lowering valve facilitates loads to be lowered particularly sensitively and proportionally.
- The standard fast lift (up to 120 kg) ensures that Euro pallets are lifted off the floor with only three pump strokes. Maximum lift height is achieved in only 5 pump strokes.



Robust forks



Operating element

## Excellent manoeuvrability

- 105° to all sides ensures maximum manoeuvrability, even in narrow aisles or on a lorry.

## Jungheinrich UK Ltd.

Head Office:

Sherbourne House · Sherbourne Drive  
Tilbrook · Milton Keynes MK7 8HX  
Phone 01908 363100  
Fax 01908 363150

info@jungheinrich.co.uk  
www.jungheinrich.co.uk

ISO 9001, ISO 14001  
Certification of Quality and  
Environment Management.



Jungheinrich trucks  
conform to the European  
Safety Requirements.



**JUNGHEINRICH**  
*Well worthwhile*

**Ideal for handling quarter/  
half pallets and special pallets**

**Width over forks manually adjustable  
(140–585 mm)**

**Particularly quiet running**

**Robust and durable**

**Fast lift as standard**



## AM V05

### Hand pallet truck for display pallets (500 kg)

The AM V05 is the perfect solution for picking up quarter and half pallets as well as full Euro pallets. It is really useful where display pallets are frequently moved e.g.

on the shop floor. Small special sized pallets can also be transported due to the adjustable forks from 140 to 585 mm, with the advantages of ease of opera-

tion, robustness and reliability similar to the standard Jungheinrich hand pallet truck.



# Technical Data in line with VDI 2198 as at: 08/2006

|                  |         |   |                                     |                     |      |
|------------------|---------|---|-------------------------------------|---------------------|------|
| Identification   | 1.1     | Manufacturer (abbreviation)                   |                                     | Jungheinrich        | 1.1  |
|                  | 1.2     | Manufacturer's type designation               |                                     | <b>AM V05</b>       | 1.2  |
|                  | 1.3     | Drive   |                                     | manual              | 1.3  |
|                  | 1.4     | Operator type                                 |                                     | hand                | 1.4  |
|                  | 1.5     | Load capacity/rated load                      | Q (t)                               | 0.5                 | 1.5  |
|                  | 1.6     | Load centre distance                          | c (mm)                              | 400                 | 1.6  |
|                  | 1.8     | Load distance, centre of drive axle to fork   | x (mm)                              | 820                 | 1.8  |
|                  | 1.9     | Wheelbase                                     | y (mm)                              | 1120                | 1.9  |
|                  | Weights | 2.1   | Service weight                      | kg                  | 155  |
| 2.2              |         | Axle loading, laden front/rear                | kg                                  | 320/325             | 2.2  |
| 2.3              |         | Axle loading, unladen front/rear              | kg                                  | 101/54              | 2.3  |
| Wheels, Chassis  | 3.1     | Tyres   |                                     | solid rubber, nylon | 3.1  |
|                  | 3.2     | Tyre size, front                              |                                     | 180x50              | 3.2  |
|                  | 3.3     | Tyre size, rear                               |                                     | 82x40               | 3.3  |
|                  | 3.4     | Additional wheels (dimensions)                |                                     |                     |      |
|                  | 3.5     | Wheels, number front rear (x = driven wheels) |                                     | 1/1                 | 3.5  |
|                  | 3.6     | Tread, front                                  | b <sub>10</sub> (mm)                | 122                 | 3.6  |
|                  | 3.7     | Tread, rear                                   | b <sub>11</sub> (mm)                | 700                 | 3.7  |
| Basic Dimensions | 4.4     | Lift  | h <sub>3</sub> (mm)                 | 390                 | 4.4  |
|                  | 4.9     | Height of tiller in drive position min./max.  | h <sub>14</sub> (mm)                | 1210                | 4.9  |
|                  | 4.15    | Height, lowered                               | h <sub>13</sub> (mm)                | 85                  | 4.15 |
|                  | 4.19    | Overall length                                | l <sub>1</sub> (mm)                 | 1405                | 4.19 |
|                  | 4.20    | Length to face of forks                       | l <sub>2</sub> (mm)                 | 450                 | 4.20 |
|                  | 4.21    | Overall width                                 | b <sub>1</sub> /b <sub>2</sub> (mm) | 760/-               | 4.21 |
|                  | 4.22    | Fork dimensions                               | s/e/l (mm)                          | 50x50x955           | 4.22 |
|                  | 4.25    | Distance between fork-arms                    | b <sub>5</sub> (mm)                 | 140-585             | 4.25 |
|                  | 4.26    | Distance between wheel arms/loading surfaces  | b <sub>4</sub> (mm)                 | 640                 |      |
|                  | 4.32    | Ground clearance, centre of wheelbase         | m <sub>2</sub> (mm)                 | 30                  | 4.32 |
|                  | 4.33    | Aisle width for pallets 1000 x 1200 crossways | Ast (mm)                            | 1805                | 4.33 |
|                  | 4.34    | Aisle width for pallets 800 x 1200 lengthways | Ast (mm)                            | 2005                | 4.34 |
|                  | 4.35    | Turning radius                                | Wa (mm)                             | 1425                | 4.35 |
| Performance Data | 5.3     | Lowering speed, laden / unladen               | m/s                                 | 0.09/0.05           | 5.3  |
|                  |         |   |                                     |                     |      |
|                  |         |   |                                     |                     |      |

# Make use of the advantages



Handling a quarter pallet



Handling a standard Euro pallet



A half pallet is picked up from a standard Euro pallet

## Flexible usage

Loading and unloading small pallets from a standard Euro pallet cannot be undertaken with a standard hand pallet truck. The AM V05 provides the solution. Due to individually adjustable forks from 140 to 585 mm, a variety of loads can also be picked up and transported. It can also, of course, pick up standard Euro pallets.

## Easy to handle

The smooth operating handle is equally suitable for left and right handed operators. Loads can be lowered smoothly with the special lowering valve.



Ergonomic handle

## Jungheinrich UK Ltd.

Head Office:

Sherbourne House · Sherbourne Drive  
Tilbrook · Milton Keynes MK7 8HX  
Phone 01908 363100  
Fax 01908 363180

info@jungheinrich.co.uk  
www.jungheinrich.co.uk

Jungheinrich UK Ltd.  
ISO 9001  
Certification of Quality  
Management.



Jungheinrich AG  
ISO 9001, ISO 14001  
Certification of Quality and  
Environment Management.



Jungheinrich trucks  
conform to the European  
Safety Requirements.



**JUNGHEINRICH**  
Well worthwhile

**Enclosed fork tips**

**Acid-resistant chassis**

**Robust and durable**

**Short and manoeuvrable**

**Grease nipples on all moving parts**



## **AM 2000 INOX/INOX PRO**

### **Stainless steel hand pallet truck (2000 kg)**

The INOX design of the Jungheinrich hand pallet truck AM is ideal for applications in damp or harsh environments. The advantages of the INOX design is also important where absolute hygiene is required. A choice

of different designs is available dependent on the application.

Decades of Jungheinrich experience in stainless steel hand pallet trucks are reflected

today in reliable and robust trucks. Whether for slaughterhouses, fish processing or for the chemical/pharmaceutical industry – the Jungheinrich stainless steel hand pallet trucks provide the right solution.

# AM 2000 INOX/INOX PRO

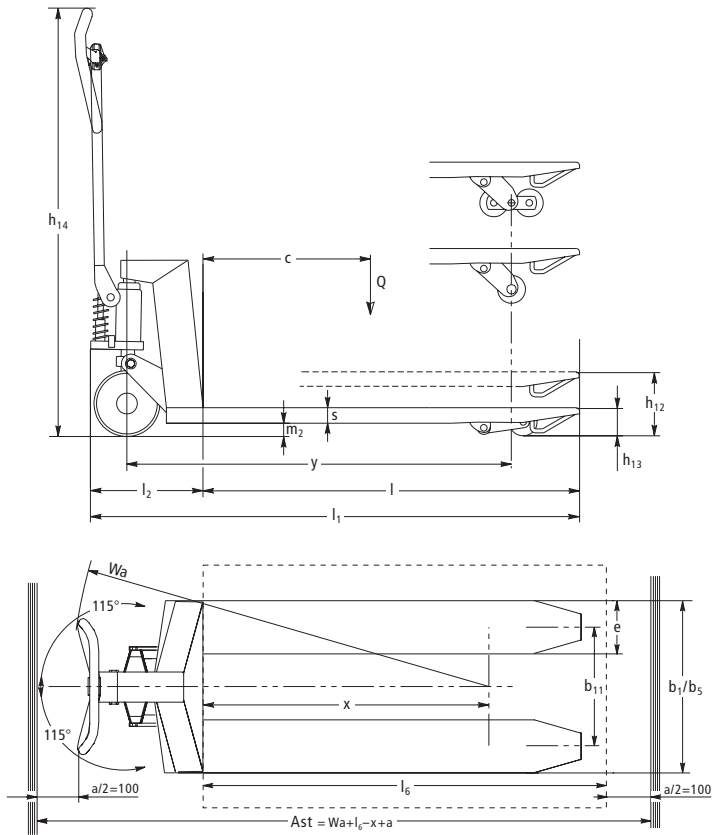

# Technical Data in line with VDI 2198 as at: 09/2005

|                  |                  |  |  |  |   |          |     |
|------------------|------------------|--|--|--|---|----------|-----|
| Identification   | 1.1              | Manufacturer (abbreviation)  | Jungheinrich                             | Jungheinrich                             | Jungheinrich                              | 1.1      |     |
|                  | 1.2              | Manufacturer's type designation                                      | <b>AM 2000 INOX/INOX PRO</b><br>(810 mm) | <b>AM 2000 INOX/INOX PRO</b><br>(970 mm) | <b>AM 2000 INOX/INOX PRO</b><br>(1140 mm) | 1.2      |     |
|                  | 1.4              | Type of operation (hand, pedestrian, standing, seated, order picker) | hand                                     | hand                                     | hand                                      | 1.4      |     |
|                  | 1.5              | Load capacity/rated load Q (t)                                       | 2  | 2  | 2   | 1.5      |     |
|                  | 1.6              | Load centre distance c (mm)  | 400                                      | 500                                      | 600                                       | 1.6      |     |
|                  | 1.8              | Load distance, centre of drive axle to fork x (mm)                   | 645                                      | 805                                      | 975                                       | 1.8      |     |
|                  | 1.9              | Wheelbase y (mm)   | 875                                      | 1035                                     | 1170                                      | 1.9      |     |
|                  | Weights          | 2.1  | Service weight kg                        | 64                                       | 66  | 68       | 2.1 |
|                  |                  | 2.2  | Axle loading, laden front/rear kg        | –  | –   | 1432/636 | 2.2 |
| 2.3              |                  | Axle loading, unladen front/rear kg                                  | –  | –  | 47/21                                     | 2.3      |     |
| Wheels, Chassis  | 3.1              | Tyres (solid rubber, superelastic, pneumatic, polyurethane)          | N; V                                     | N; V                                     | N; V                                      | 3.1      |     |
|                  | 3.2              | Tyre size, front   | 200                                      | 200                                      | 200                                       | 3.2      |     |
|                  | 3.3              | Tyre size, rear  | 80x90/80x70                              | 80x90/80x70                              | 80x90/80x70                               | 3.3      |     |
|                  | 3.5              | Wheels, number front/rear (x = driven wheels)                        | 2/2 or 2/4                               | 2/2 or 2/4                               | 2/2 or 2/4                                | 3.5      |     |
|                  | 3.6              | Track width, front b <sub>10</sub> (mm)                              | 360                                      | 360                                      | 360                                       | 3.6      |     |
|                  | 3.7              | Track width, rear b <sub>11</sub> (mm)                               | 130                                      | 130                                      | 130                                       | 3.7      |     |
|                  | Basic Dimensions | 4.4  | Lift height h <sub>3</sub> (mm)          | 115                                      | 115                                       | 115      | 4.4 |
| 4.9              |                  | Height of tiller in drive position min./max. h <sub>14</sub> (mm)    | 1220                                     | 1220                                     | 1220                                      | 4.9      |     |
| 4.14             |                  | Standing height, elevated h <sub>12</sub> (mm)                       | 200                                      | 200                                      | 200                                       | 4.14     |     |
| 4.15             |                  | Lowered height h <sub>13</sub> (mm)                                  | 85                                       | 85                                       | 85  | 4.15     |     |
| 4.19             |                  | Overall length l <sub>1</sub> (mm)                                   | 1150                                     | 1310                                     | 1480                                      | 4.19     |     |
| 4.20             |                  | Length to face of forks l <sub>2</sub> (mm)                          | 340                                      | 340                                      | 340                                       | 4.20     |     |
| 4.22             |                  | Fork dimensions s/e/l (mm)   | 45/160/810                               | 45/160/970                               | 45/160/1140                               | 4.22     |     |
| 4.25             |                  | Width over forks b <sub>5</sub> (mm)                                 | 520/680                                  | 520/680                                  | 520/680                                   | 4.25     |     |
| 4.32             |                  | Ground clearance, centre of wheelbase m <sub>2</sub> (mm)            | 38                                       | 38                                       | 38  | 4.32     |     |
| 4.33             |                  | Aisle width for pallets 1000x1200 crossways Ast (mm)                 | 1340                                     | 1340                                     | 1340                                      | 4.33     |     |
| 4.34             |                  | Aisle width for pallets 800x1200 lengthways Ast (mm)                 | 1740                                     | 1740                                     | 1740                                      | 4.34     |     |
| Performance Data | 5.3              | Lowering speed, laden/unladen m/s                                    | 0.09/0.04                                | 0.09/0.04                                | 0.09/0.04                                 | 5.3      |     |
|                  |                  |  |  |  |   |          |     |

# Make use of the advantages



Handle

## Easy to use

The "easy to operate" handle is equally suitable for left- or right-handed operators. The special lowering valve allows the loads to be lowered with particular sensitivity.

## Optimum hygiene

The enclosed fork tips ensure that splatters of dirt cannot reach the load. Freely accessible or completely enclosed openings facilitate effective cleaning with no "hiding places for bacteria". Grease nipples on all moving parts and lubricants suitable for foodstuff (class H1 and H2) are used as standard.

## Fast operation

The very short chassis length of 340 mm gives safe and easy operation even in most confined spaces. Easy fork entry and exit is ensured through pallet skids on the fork tips.



Enclosed fork tips

## AM 2000 INOX

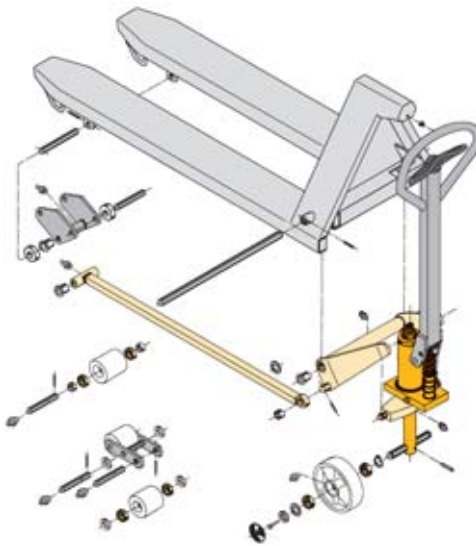

Trucks made 100% of stainless steel are not always required. Only those components that come in direct contact with food must be made of stainless steel. Some components only need to be moisture repellent. This is the reason why AM 2000 INOX components consist of different materials.

- Chassis: acid-resistant stainless steel (AISI 316)
- Tiller: stainless steel (AISI 303/304)
- Pump: electro-galvanised and yellow chromed
- Axle: stainless steel (AISI 303/304)
- Lifting lever: hot-dip galvanised
- Tie rod: hot-dip galvanised
- Support arm lever: stainless steel (AISI 303/304)

## AM 2000 INOX PRO

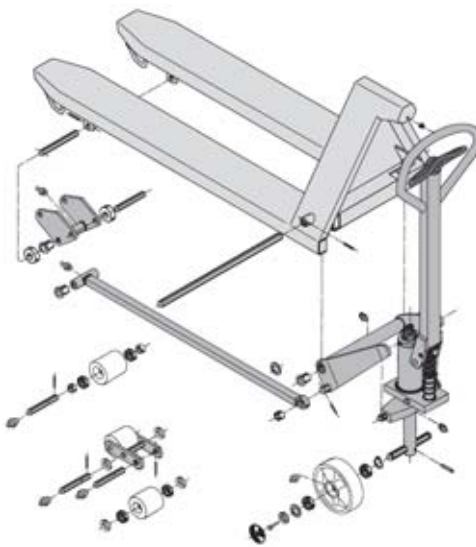

The AM 2000 INOX PRO is 100% protected against rust and was specially designed for applications where hygiene is of utmost importance. Its hydraulics are protected and foreign bodies and water cannot penetrate it.

- Chassis: acid-resistant stainless steel (AISI 316)
- Tiller: stainless steel (AISI 303/304)
- Pump: stainless steel (AISI 303/304)
- Axle: stainless steel (AISI 303/304)
- Lifting lever: stainless steel (AISI 303/304)
- Tie rod: stainless steel (AISI 303/304)
- Support arm lever: stainless steel (AISI 303/304)

## Jungheinrich UK Ltd.

### Head Office:

Sherbourne House  
 Sherbourne Drive  
 Tilbrook  
 Milton Keynes MK7 8HX  
 Telephone 01908 363100

info@jungheinrich.co.uk  
 www.jungheinrich.co.uk

ISO 9001, ISO 14001  
 Certification of Quality and  
 Environment Management.



Jungheinrich trucks  
 conform to the European  
 Safety Requirements.



**JUNGHEINRICH**  
*Well worthwhile*

**Accurate weighing technology  
for warehouse, production  
and despatch**

**4 weighing cells technology  
for professional weighing processes**

**Variations for almost every  
weighing application**

**Operating handle suitable for both  
left and right-handed operators**



## **AMW 22/22p**

### **Hand pallet truck with weighing scales (2200 kg)**

The hand pallet trucks AMW 22 and AMW 22p are mobile weighing scales for warehouse, production and despatch. Wherever goods need to be weighed and transported these hand pallet trucks are the ideal solution, as they bring the weighing scales to the goods.

For example, the basic model of the AMW 22 provides an efficient and accurate weighing device suitable for any application due to 4 weighing cells technology. 1 kg display stages and a maximum of 0.1 % deviation from the measuring range are exactly the right standard for a wide range of applications.

The AMW 22p is even more professional. This weighing pallet truck with its numerous functions allows for individual adjustments for every application. A multi-range display, maximum precision (99.9 % minimum of weighed weight), various options and the well designed battery change module make the AMW 22p a first class truck.

# AMW 22/22p

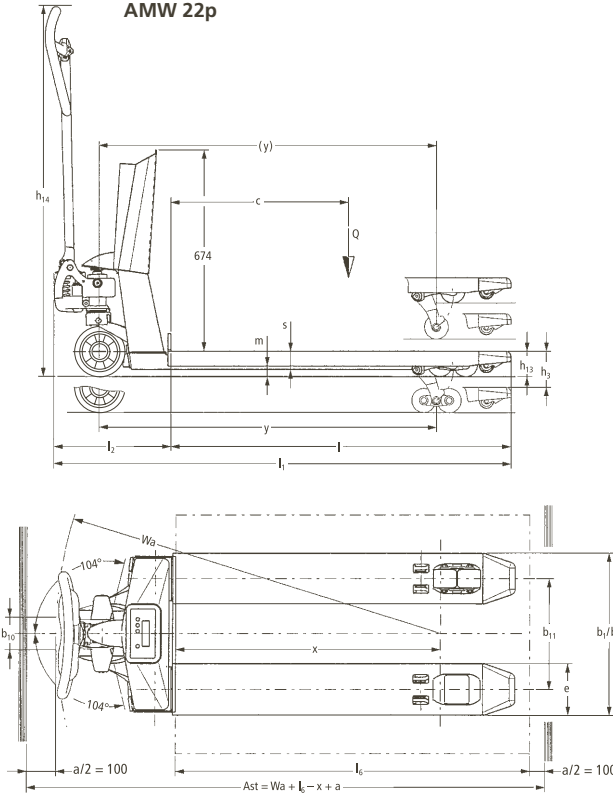
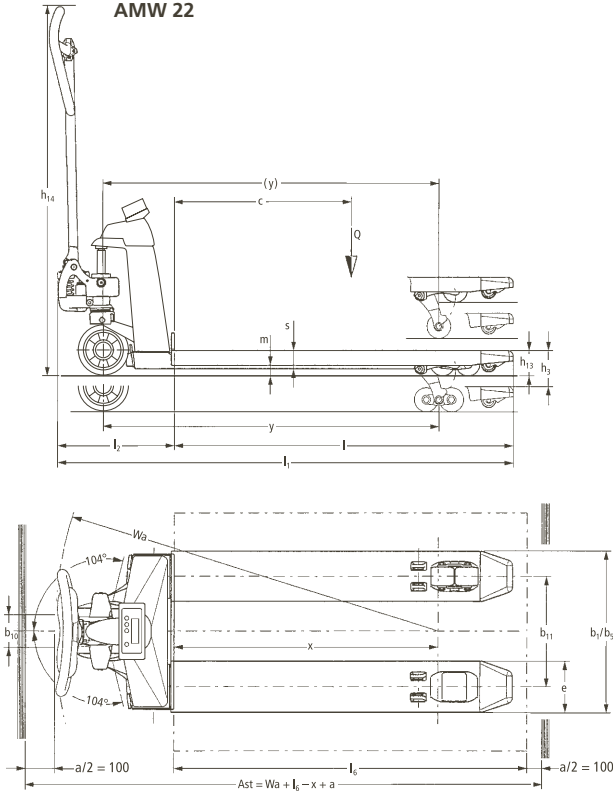

# Technical data in line with VDI 2198 as at: 01/2007

|                  |                  |   |                                     |                            |      |
|------------------|------------------|---|-------------------------------------|----------------------------|------|
| Identification   | 1.1              | Manufacturer (abbreviation)                   |                                     | Jungheinrich               | 1.1  |
|                  | 1.2              | Manufacturer's type designation               |                                     | <b>AMW 22/AMW 22p</b>      | 1.2  |
|                  | 1.3              | Drive   |                                     | manual                     | 1.3  |
|                  | 1.4              | Operator type                                 |                                     | hand                       | 1.4  |
|                  | 1.5              | Load capacity/rated load                      | Q (t)                               | 2.2                        | 1.5  |
|                  | 1.6              | Load centre distance                          | c (mm)                              | 600                        | 1.6  |
|                  | 1.8              | Load distance, centre of drive axle to fork   | x (mm)                              | 890                        | 1.8  |
|                  | 1.9              | Wheelbase                                     | y (mm)                              | 1110                       | 1.9  |
|                  | Weights          | 2.1   | Service weight                      | kg                         | 99   |
| 2.2              |                  | Axle loading, laden front/rear                | kg                                  | 578/1721                   | 2.2  |
| 2.3              |                  | Axle loading, unladen front/rear              | kg                                  | 61/38                      | 2.3  |
| Wheels, Chassis  | 3.1              | Tyres   |                                     | Solid rubber, Polyurethane | 3.1  |
|                  | 3.2              | Tyre size, front                              |                                     | 170 x 44                   | 3.2  |
|                  | 3.3              | Tyre size, rear                               |                                     | 82 x 96/82 x 62            | 3.3  |
|                  | 3.5              | Wheels, number front rear (x = driven wheels) |                                     | 2/2 or 2/4                 | 3.5  |
|                  | 3.6              | Tread, front                                  |                                     | 109                        | 3.6  |
|                  | 3.7              | Tread, rear                                   | b <sub>11</sub> (mm)                | 370                        | 3.7  |
|                  | Basic Dimensions | 4.4   | Lift                                | h <sub>3</sub> (mm)        | 122  |
| 4.9              |                  | Height of tiller in drive position min./max.  | h <sub>14</sub> (mm)                | 1234                       | 4.9  |
| 4.15             |                  | Height, lowered                               | h <sub>13</sub> (mm)                | 86                         | 4.15 |
| 4.19             |                  | Overall length                                | l <sub>1</sub> (mm)                 | 1546 <sup>1)</sup>         | 4.19 |
| 4.20             |                  | Length to face of forks                       | l <sub>2</sub> (mm)                 | 396                        | 4.20 |
| 4.21             |                  | Overall width                                 | b <sub>1</sub> /b <sub>2</sub> (mm) | 540/700                    | 4.21 |
| 4.22             |                  | Fork dimensions                               | s/e/l (mm)                          | 62 x 170 x 1150            | 4.22 |
| 4.25             |                  | Distance between fork-arms                    | b <sub>5</sub> (mm)                 | 540/700                    | 4.25 |
| 4.32             |                  | Ground clearance, centre of wheelbase         | m <sub>2</sub> (mm)                 | 24                         | 4.32 |
| 4.33             |                  | Aisle width for pallets 800 x 1200            | Ast (mm)                            | 1734                       | 4.33 |
| 4.34             |                  | Aisle width for pallets 800 x 1200 lengthways | Ast (mm)                            | 1784                       | 4.34 |
| 4.35             |                  | Turning radius                                | Wa (mm)                             | 1303                       | 4.35 |
| Performance Data | 5.3              | Lowering speed, laden/unladen                 | m/s                                 | 0.09/0.02                  | 5.3  |

1) with fork length 1150 mm

# Make use of the advantages

## Easy to handle

The operating handle is equally suitable for both left and right handed operators. The special lowering valve allows for loads up to 1000 kg to be lowered particularly sensitively. The standard fast lift (to 120 kg) ensures that Euro pallets are lifted off the floor with only three pump strokes and the maximum lift height is achieved in 5 pump strokes.

## Maximum precision

The weighing cells are positioned at the four end points of the forks and ensure extremely precise weight recording up to a slanting position of 2°.

## Thoroughly robust

Maximum stability is achieved through the well proven fork construction. Electronics and display are protected against dust and water (protection class IP 65).

## A truck to suit your application

Two different types of pallet trucks with weighing scales are available to ensure the optimum economic solution for every application.



AMW 22 – display/operation

## Performance characteristics AMW 22:

- 2200 kg weighing capacity.
- Fast lift.
- 1 kg display stages over the entire measuring range up to 2200 kg.
- 0.1 % maximum deviation from measuring range.
- Protected against moisture and dust (protection class IP 65).
- Automatic zero correction, also via the keyboard.
- Taring over the entire weighing range.
- Voltage supply via 4 x AA, 1.5 V batteries is sufficient for approximately 1700 weighing processes.
- Automatic switch-off after 3 minutes idle time.

## Special equipment AMW 22:

- Tandem design.



AMW 22p – display/operation

## Performance characteristics AMW 22p:

- Automatic multi-range display:
 

| Measuring interval | Measuring range |
|--------------------|-----------------|
| 0.2 kg             | up to 200 kg    |
| 0.5 kg             | up to 500 kg    |
| 1.0 kg             | up to 2200 kg   |
- After weight taring, the LC display is automatically adjusted to the lower weight.
- 0.1 % maximum deviation from the weighed weight.
- Protected against moisture and dust (protection type IP 65).
- Plug-in battery module with 12 V/1.2 Ah incl. charger
- 60 hours operating time
- Automatic switch-off after 30 minutes idle time.

## Special equipment AMW 22p:

- Optional special functions:
  - Unit counting by entering or establishing unit weight.
  - Key button for weight display in either kg or lbs.
  - Background lighting for display.
  - Date and time.
  - Battery discharge indicator.
  - Entry of 5-digit codes.
- More precise multi-range display:
 

| Measuring interval | Measuring range |
|--------------------|-----------------|
| 0.1 kg             | up to 200 kg    |
| 0.2 kg             | up to 400 kg    |
| 0.5 kg             | up to 2000 kg   |
- Calibrated designs grade III (EU registration No. T 2782).
- Additional battery change module.
- Integrated printer.
- Special fork dimensions.
- Wheel brake and parking brake, foot brake.
- Antistatic steering wheel.



Maximum precision with AMW 22p



Efficient weighing with AMW 22

## Jungheinrich UK Ltd.

### Head Office:

Sherbourne House · Sherbourne Drive  
 Tilbrook · Milton Keynes MK7 8HX  
 Phone 01908 363100  
 Fax 01908 363180

info@jungheinrich.co.uk  
 www.jungheinrich.co.uk

Jungheinrich AG  
 ISO 9001, ISO 14001  
 Certification of Quality and  
 Environment Management.



Jungheinrich trucks  
 conform to the European  
 Safety Requirements.



**JUNGHEINRICH**  
*Well worthwhile*